

OP-560

Do not discard any of the packaging until you have checked all the parts and the package of fittings. If you are missing any of the parts, please contact the store from which you purchased your products. The staff will do their best to help you.

Check-List

01



02

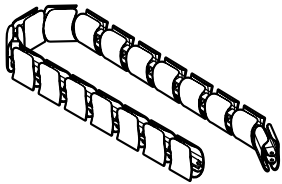

03

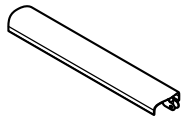

04



Dimension

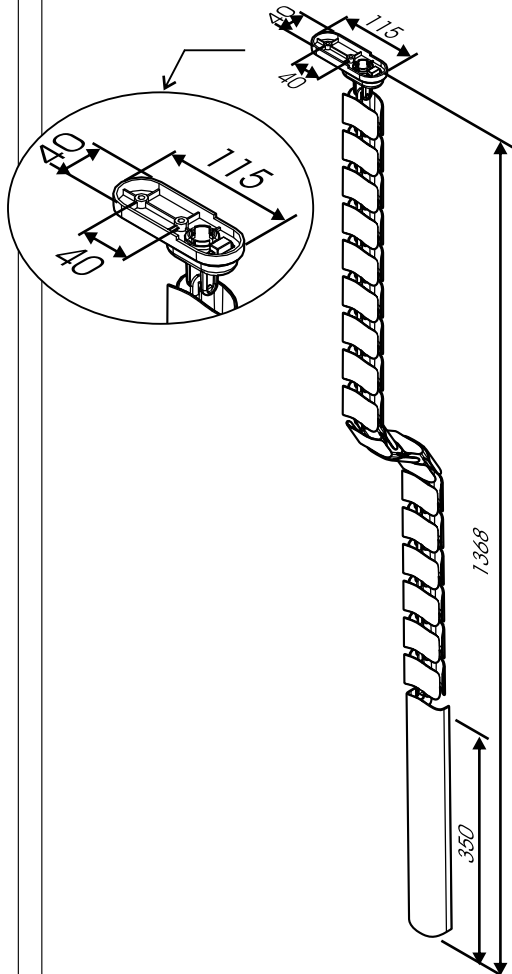

Assembly Guide

Assembly Guide

Step 1

Fix the top bracket of cable manager under the desk with screwdriver (not provided).

- Suggested desk thickness: 20mm or above

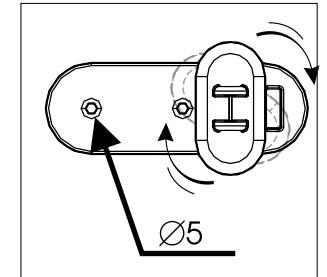

The bracket is available to rotate according to the needs.

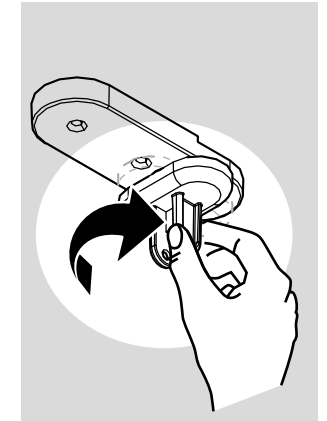
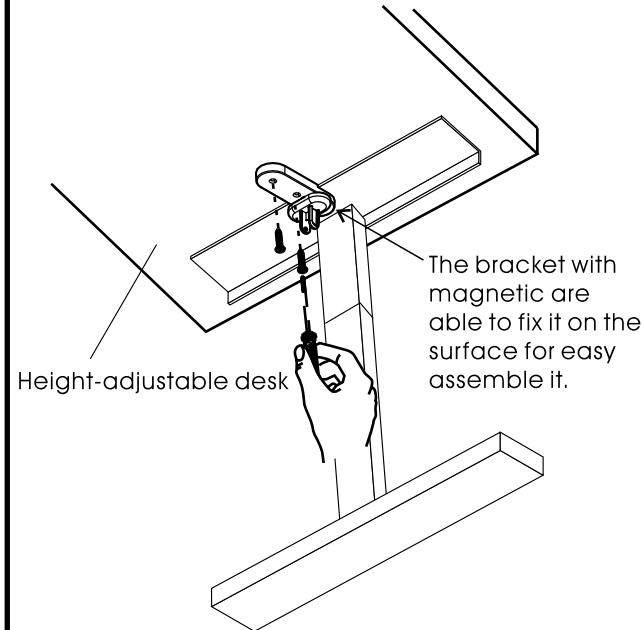

Step 2

Connect the cable manager and top bracket.

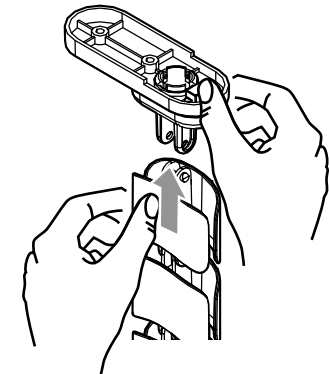

Assembly Guide

Step 3

Connect the cable manager and cable cover.

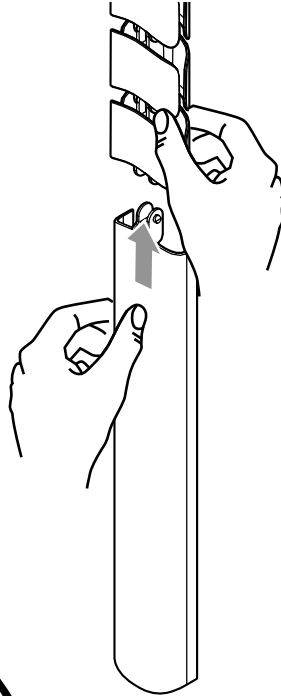

Step 4

Route cables from desk to floor.

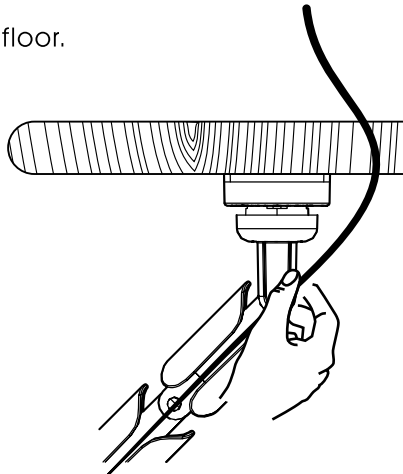

Step 5

Easy disassembling when required.

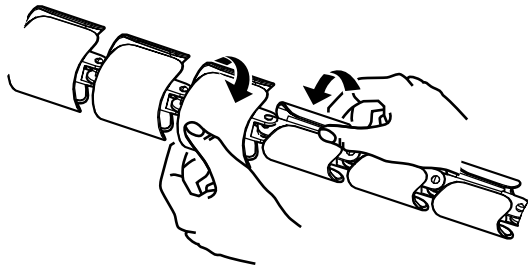

Assembly Guide

The bracket is available to rotate according to the needs.

